

Completion Date: Q3 2025



Vertex
CENTRAL

LTS No.: LS-07-21-015



Artist's Impression

Completion Date: Q3 2025



LTS No.: LS-07-21-015



*Right in the
Center of it All*



Building Floor Plans



No. of Units Left: **10**

Residential Units (17th to 34th Floor)

Amenity Floor (16th Floor)

Small Office/Home Office Units (8th to 16th Floor)

Basement to Podium Parking (B2 to 7th Floor)

Features and Amenities



Lobby

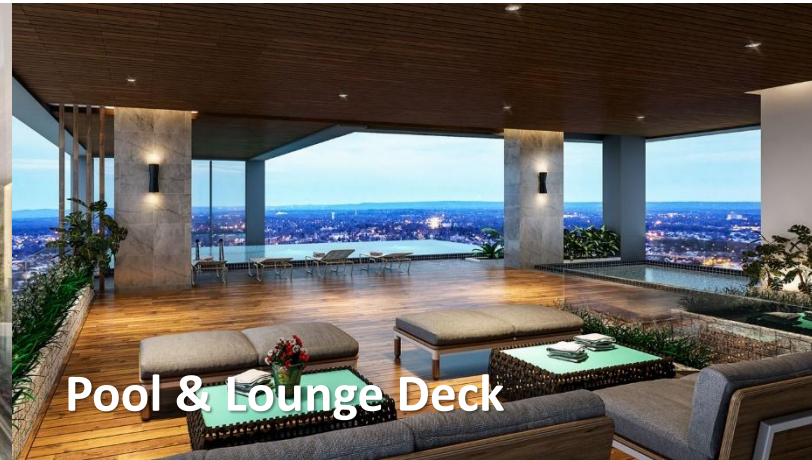

Pool & Lounge Deck



Gym



Commercial Spaces

A modern, compact office or studio unit. The room features a white desk with a computer monitor, a lamp, and a black office chair. A corkboard with various photos and notes is mounted on the wall above the desk. A large window on the right side offers a view of a city. In the center, there is a small glass table with two brown armchairs and a laptop. A white shaggy rug is placed under the table. The floor is made of light-colored wood. The ceiling has recessed lighting. The overall design is clean and functional.

Small Office/Home Office Units Studio Units

Small Office/Home Office Studio Units



Studio Home Office 1
HO-A1 = 22.40 sq. m.
8th – 15th Floor



Studio Home Office 2
HO-A2 = 22.40 – 37.20 sq. m.
8th Floor



Studio Home Office 3
HO-A3 = 22.40 sq. m.
16th Floor

Small Office/Home Office Units

1-bedroom Units



Small Office/Home Office 1-bedroom Units



1-bedroom Home Office 1
HO-B1 = 42.55 sq. m.
9th – 15th Floor

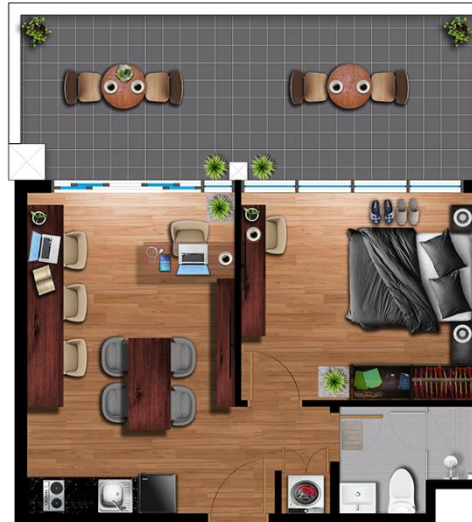

1-bedroom Home Office 3
HO-B3 = 64.60 – 71.60 sq. m.
8th Floor

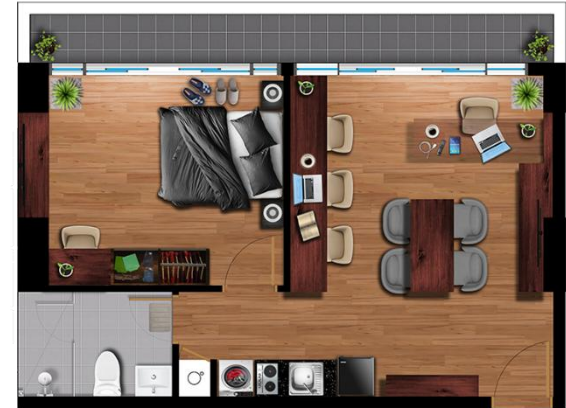

1-bedroom Home Office 4
HO-B4 = 56.85 – 73 sq. m.
8th Floor



**Studio
Residential Units**

Studio Residential Units



Studio Residence 1
RU-A1 = 22.40 sq. m.
17th – 32nd Floor



Studio Residence 3
RU-A3 = 34.55 sq. m.
17th – 18th Floor



1-bedroom
Residential Units

1-bedroom Residential Units



1-bedroom Residence 1
RU-B1 = 42.55 sq. m.
17th – 34th Floor



1-bedroom Residence 2
RU-B2 = 51.70 sq. m.
17th – 32nd Floor



SELLING POINTS

- Located in between two major business districts: Cebu IT Park and Cebu Business Park making it an ideal base for people on-the-go
- Great investment opportunity with high property value
- Due to its strategic location, there is a demand for office rentals that can generate passive income
- Complete amenities for leisure and convenience
- Easy for your customers to locate your business office
- Currently the only project selling office units in between business districts
- Few minutes walk to your favorite mall and dining establishments



SAMPLE COMPUTATION

	STUDIO SOHO	1 BR SOHO
RESERVATION FEE	P 20,000	P 25,000
EQUITY <i>Payable for 18 mos</i>	P 38,743	P 60,837
LOANABLE AMOUNT <i>THROUGH BANK FINANCING</i>	P 6,456,260	P 10,080,526
TOTAL CONTRACT PRICE	P 7,173,622	P 11,200,584



Fiesta



REWARDS! BUYER'S PROMO

STUDIO UNITS

RESERVATION: 20K

STRAIGHT MONTHLY

10% EQUITY
FOR 18 MONTHS

STEP-UP PAYMENT

10% EQUITY
FOR 18 MONTHS
FOR AS LOW AS 5K PER MONTH

PARKING UNITS

RESERVATION: 10K
20% EQUITY
FOR 18 MONTHS

1 BEDROOM UNITS

RESERVATION: 25K

STRAIGHT MONTHLY

10% EQUITY
FOR 18 MONTHS

STEP-UP PAYMENT

10% EQUITY
FOR 18 MONTHS
FOR AS LOW AS 10K PER MONTH

+

100K FURNITURE GC
(UPON MOVE IN)



CONSTRUCTION UPDATE



CONSTRUCTION UPDATE
JUNE 2025

